

# BLUFF ROAD IMPROVEMENTS

## WASHINGTON, MISSOURI

**Year:** 2018  
**Client:** City of Washington  
**Project Manager:** Mark A. Harriman

**Contact:** Sandy Lucy, Mayor  
405 Jefferson St  
Washington, MO 63090  
(636) 390-1000

BFA worked with the City of Washington to prepare design plans, bid documents, job special provisions, project cost estimates, and construction oversight. The project scope included designing a new 300 ft dedicated turn lane and taper on Bluff Road at the intersection of Highway 100, a profile grade adjustment to 600 ft of roadway, and approximately 5,000 ft of 4" overlay. A critical part of this project included detailed traffic control plans to ensure effective traffic management within the industrial park. BFA added value to the project by designing a temporary traffic signal to maintain efficient traffic flow, minimizing the impact on local industries. Through our insight and expertise, we also inspected three large 60" culverts that needed to be replaced during construction. These culverts were designed to be replaced with precast concrete box culverts. This precast concrete option has a very long life span and enables the contractor to install it quickly, minimizing disruption to traffic. BFA also provided daily MoDOT reporting and weekly erosion inspections.



### Subconsultants:

SCI - Geotechnical Engineering  
EFK Moen, LLC - Traffic Engineering

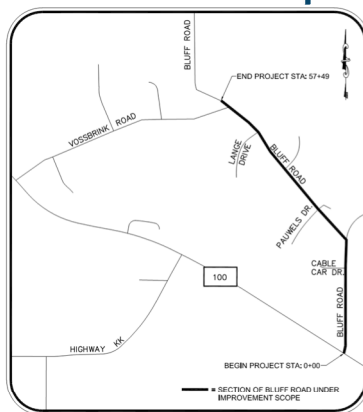

**SITE LOCATION MAP**  
NOT TO SCALE

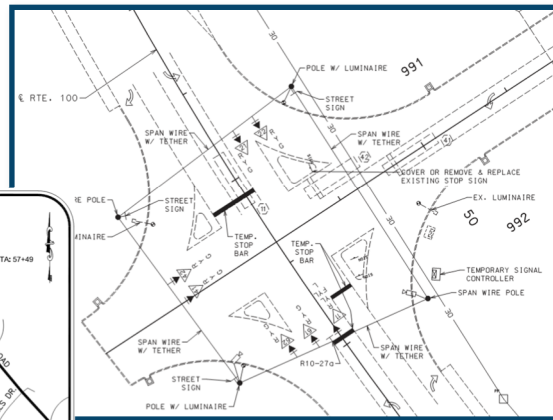

Base Bid Cost Estimate: \$1,404,059.10  
Low bid: \$1,232,073.00  
Alternate Bid No. A Cost Estimate: \$1,389,059.10  
Low bid: \$1,212,673.00  
Alternate Bid No. 1 Cost Estimate: \$1,397,059.10  
Low bid: \$1,228,469.00  
Construction Project Estimated Time: 90 Days  
Construction Engineering Estimate: \$61,100.00